

**Ball Bearing Slides**



**Firm Close Drawers**



**Key Lock**

Edition : 1.0  
Date: (1/25)

# Instruction Manual

# STEEL SERVICE CART SDC-2L

Order Code: (T751)

## BEFORE ASSEMBLING

Please read this instruction manual before assembly.



### CAUTION

Before assembly please pay attention to the following points in priority;

**Confirmation of components:** Before assembling, please confirm all parts arrived and are in good order.

**Site for assembly:** Please assemble it on the soft floor such as smooth carpet and flannel blanket. When you assemble on wooden floor, please put thin towels on the floor.

**Points for attention when assembling:** Please wear gloves to ensure that it can be assembled safely, and use two persons to help in the assembly process.

## SAFETY INFORMATION

1. Do not pull this service cart, push it when moving.
2. Engage both brakes when this service cart is not being moved. This prevents the service cart rolling away.
3. Secure this service cart properly before moving with a forklift.
4. Do not tow this service cart with power equipment.
5. Do not alter this service cart in any manner. For Example. Do not weld external lock bars or attach electrical equipment.
6. Before locking the service cart, ensure the drawers and top table slides are completely closed in order for the lock system to engage properly.



**CAUTION:** Do not attach or mount this product to a vehicle. This may cause personal injury or product damage. Mounting this product to any vehicle in any manner will void warranty.



**CAUTION:** Keep the product on level surfaces. The product may become unstable and tip if stored or moved on an un-level surface, which may cause personal injury or product damage.



**CAUTION:** Do not stand on this product. You may fall which may cause personal injury or product damage.



**CAUTION:** Lock the drawers before moving this product. The drawers could come open and make the product unstable and tip, which may cause personal or product damage.



**CAUTION:** Be careful when opening more than one drawer. The product may become unstable and tip, which may cause personal injury or product damage.



# STEEL SERVICE CART



## SPECIFICATIONS

- Overall size, lid closed....705 x 370 x 835mm (LxWxH)
- Overall size, lid open ..... 1205 x 370 x 835mm (LxWxH)
- Top Access Opening .....500 x 300mm (LxW)
- Top Compartment Area ..690 x 360 x 170mm (LxWxH)  
40kg load capacity
- Lower tray with sides .....700 x 360 x 80mm (LxWxH)
- Lower tray area.....700 x 360 x 375mm (LxWxH)  
40kg load capacity
- Side storage tray .....360 x 100 x 60mm (LxWxH)
- Top table flat area.....2 x 350 x 305mm (LxW)
- Drawer area .....565 x 325 x 55mm (LxWxH)  
8kg load capacity each
- Total Load Limit: 100kg
- Nett Weight: 30.5kg

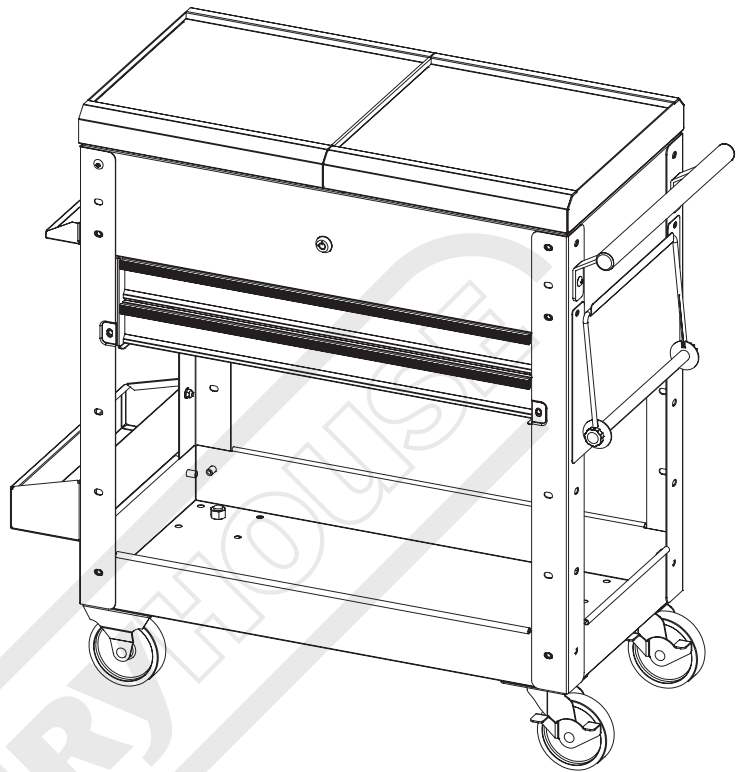

Detent Lock On  
Top Lid



Paper Towel  
Holder

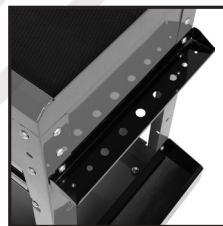

Screwdriver  
Holder



Keys (x2)

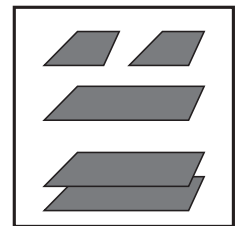

Liners (x5)

## KEY / LOCKING OPERATION

**KEY LOCK** - will lock the entire service cart and drawers

**SLIDING TOPS CLOSED** - will lock drawers

# STEEL SERVICE CART



## PARTS LIST

Carefully unpack and spread out all parts in a large uncluttered area.

Familiarize yourself with all parts and compare them with the drawing below to make sure none are missing. Read all assembly instructions before beginning.

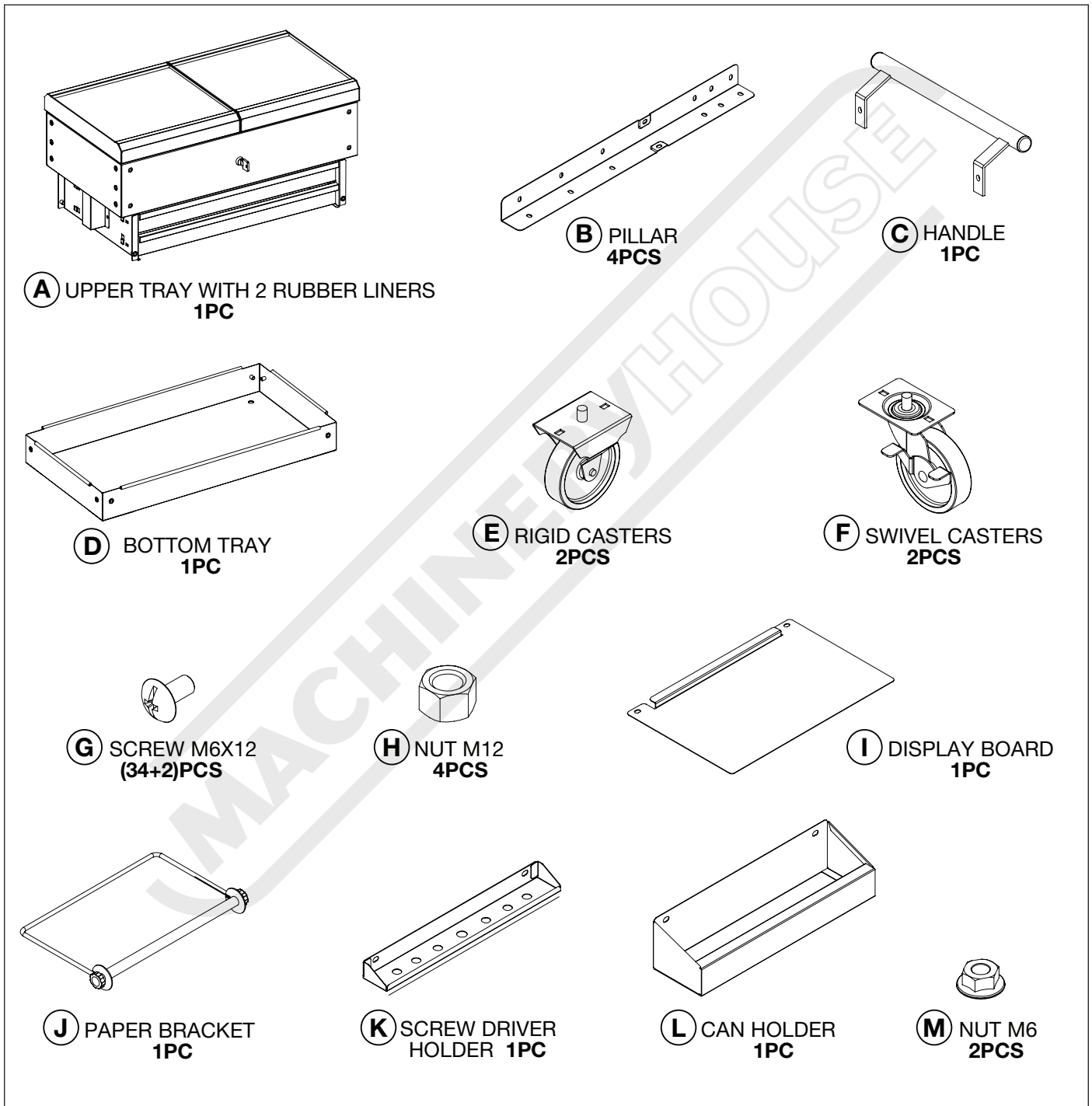

**TOOLS REQUIRED** : Phillips screwdriver, 6 & 12mm spanners or socket wrench.

## ASSEMBLY INSTRUCTIONS

### TOOLS & ASSISTANCE NEEDED

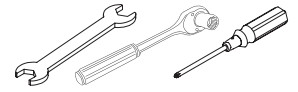

12mm Spanner or Socket Wrench  
Philips Head Screwdriver

\*Tools not included

### STEP 1

Attached rigid wheels #E to one side and the swivel wheels #F to the other side using M12 Nuts #H.

NOTE: Swivel Wheels #F and Handle #C are to be attached on the same side. Can mount either side.

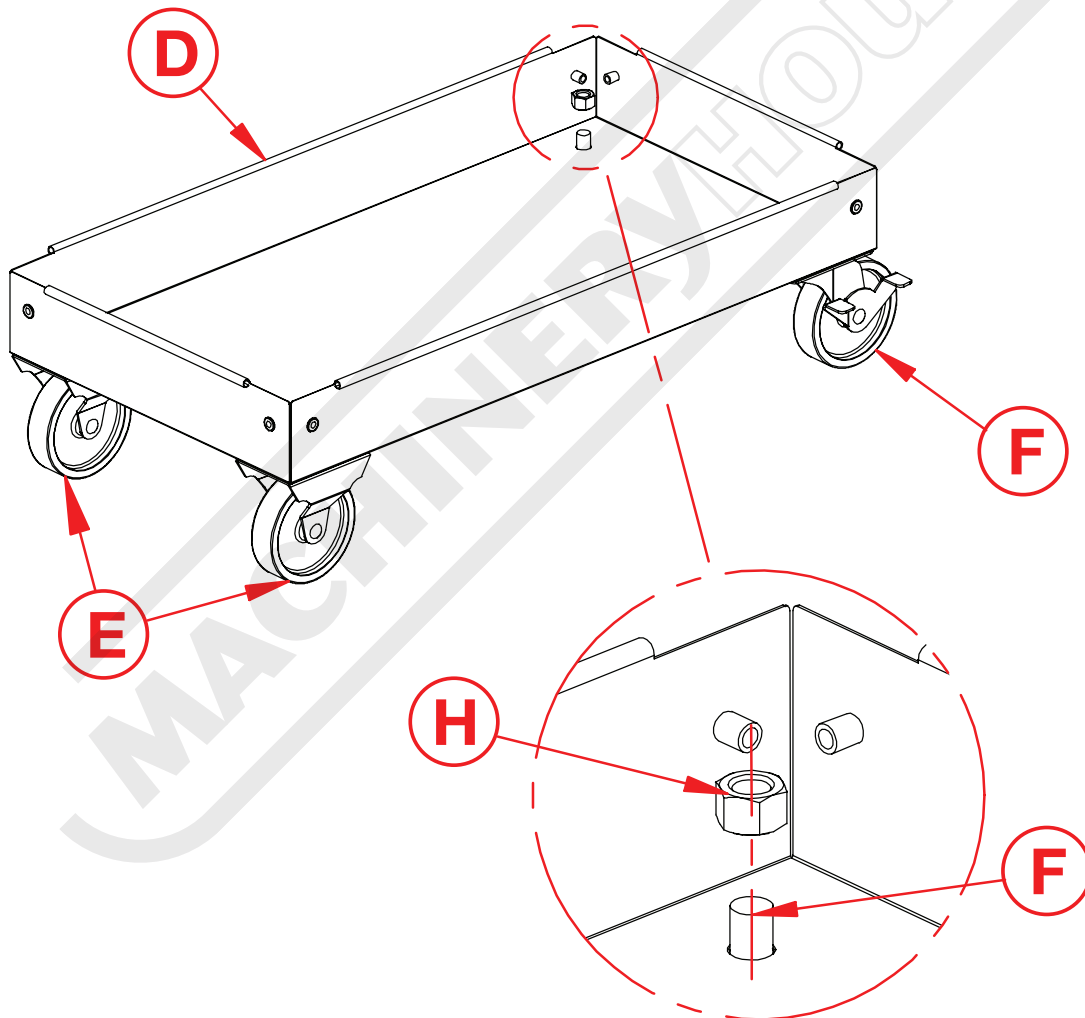

Note: Always put the same casters on one side.  
Place Swivel Casters & Handle on same side

# STEEL SERVICE CART



## ASSEMBLY INSTRUCTIONS

### TOOLS & ASSISTANCE NEEDED



12mm Spanner or Socket Wrench  
Philips Head Screwdriver

\*Tools not included

## STEP 2

Attached the four pillars #B to the outside corners of the bottom tray #D using M6x12 screws #G.

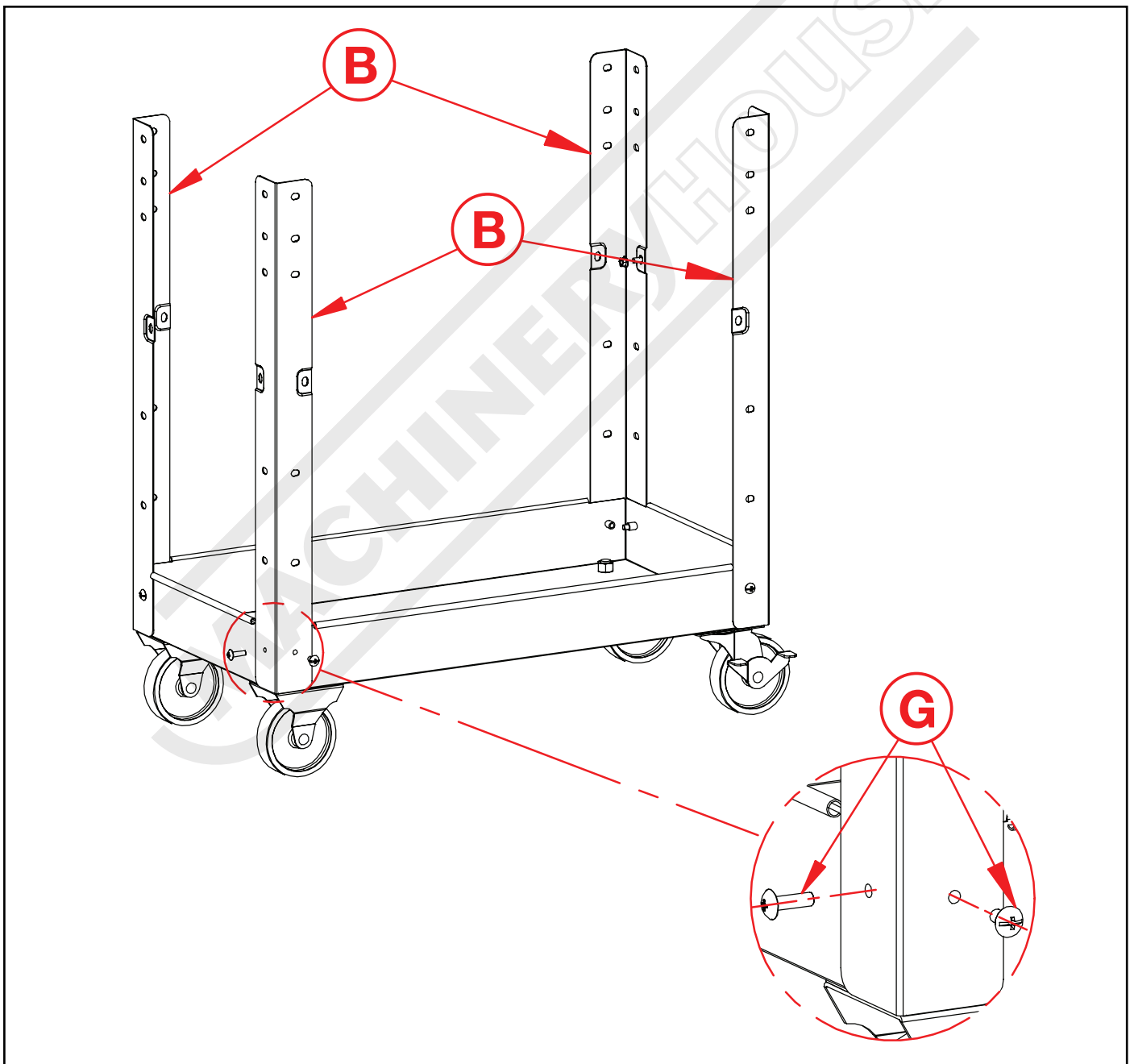

## ASSEMBLY INSTRUCTIONS

### STEP 3

Attach and insert the upper tray #A into the top of the pillars #B and also attached the screw driver holder #K using M6x12 screws #G. Then attach the and can holder #L using 6x12 screws #G & M6 nuts #M.

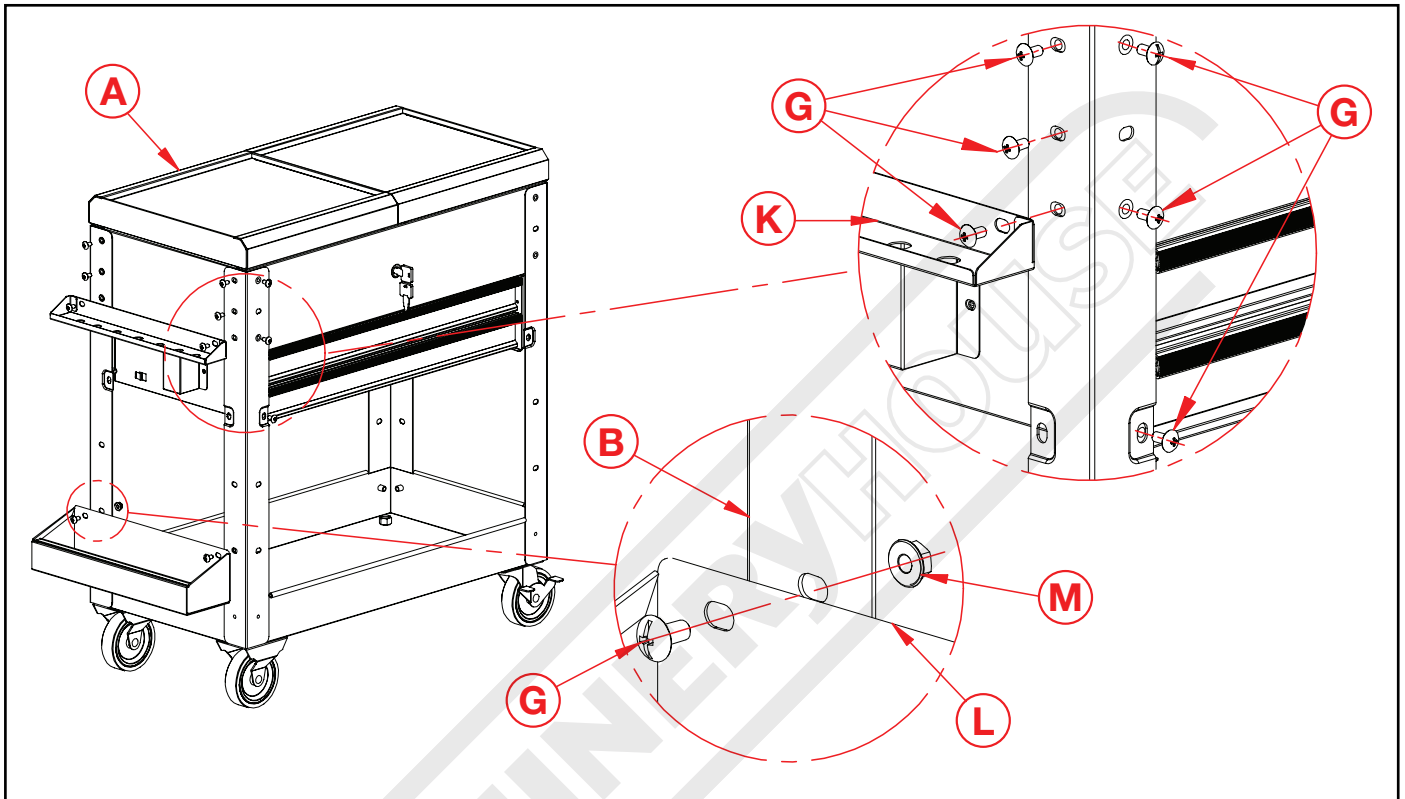

### STEP 4

Attach the handle #C and paper bracket #J using M6x12 screws #G.

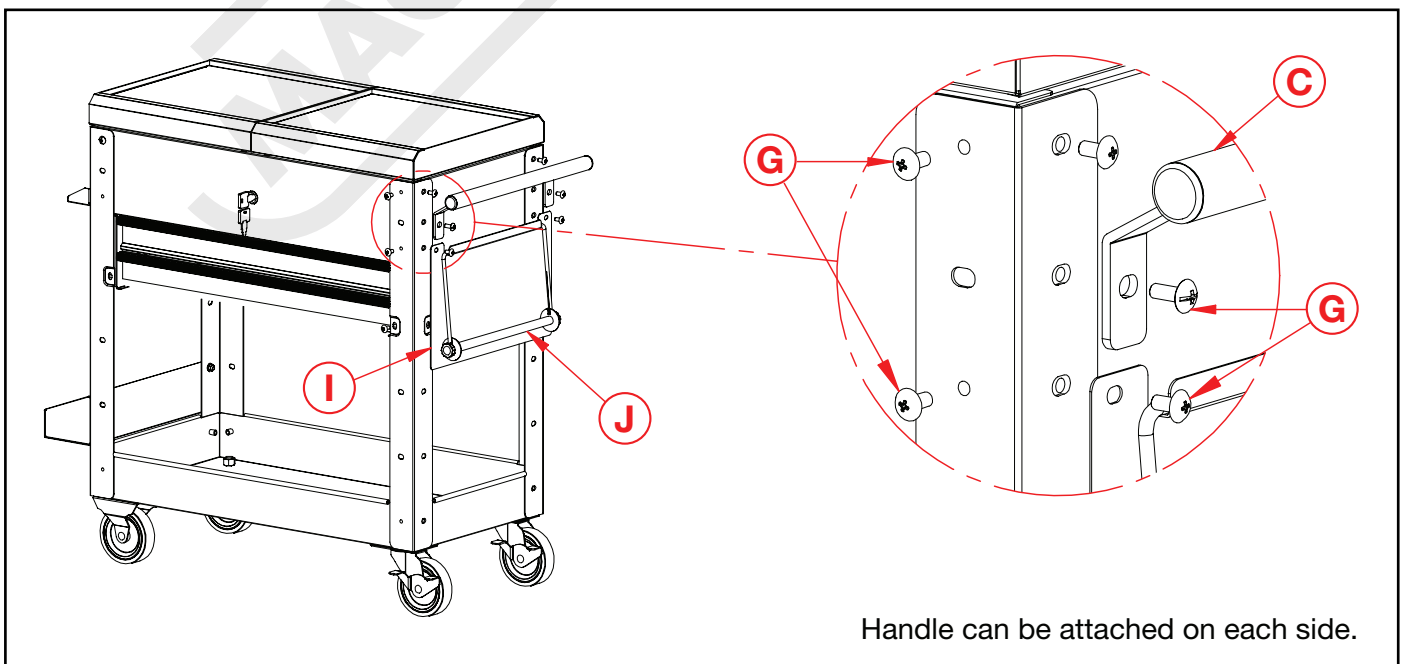

## DRAWER REMOVAL / RE-INSERTING

1.

### Removing the drawers

- Fully extend the empty drawer.
- Push up the one release lever while pulling down on the other release lever.
- Pull the drawer outward until it is released from the drawer slide.

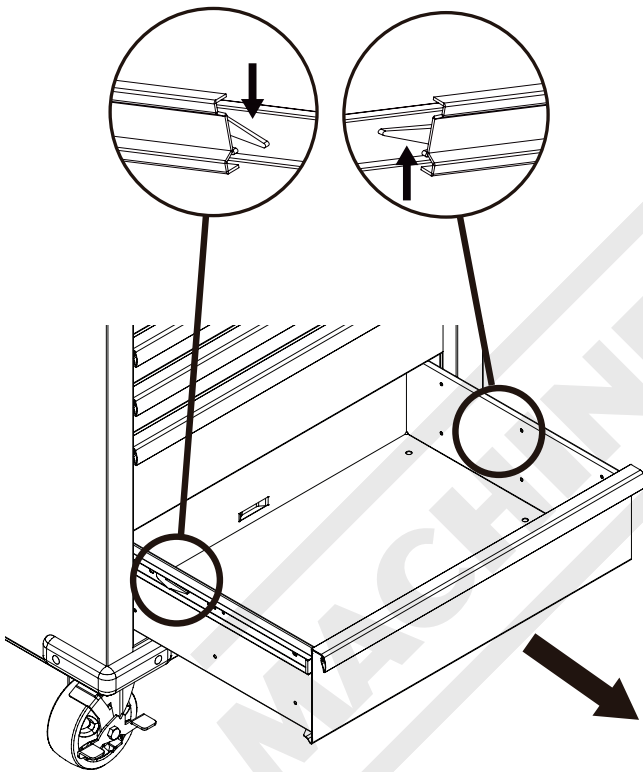

2.

### Re-inserting the drawers

- Extend the drawer slides.
- Insert the brackets on each side of the drawer into the slots in the slides, being careful that they are properly positioned.
- Once properly inserted, completely close the drawer to set the slides in their proper positions and make sure you go all the way in to engage the firm close drawer system.

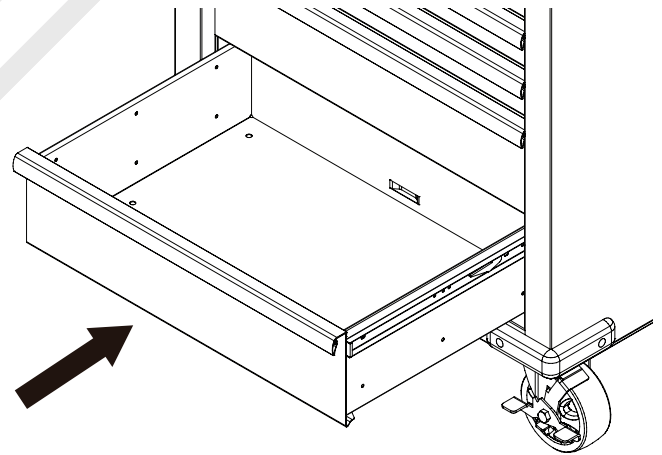

NOTE: Image is for illustrative purpose only and may not be an exact representation of the product.

## MAINTENANCE

1. Wheel maintenance: Grease the wheels annually using high-quality bearing grease.
2. Drawer maintenance: Lubricate the slides semi-annually with high-quality bearing grease.
3. Lubricate the lock with graphite annually.

# STEEL SERVICE CART



## DIMENSIONS

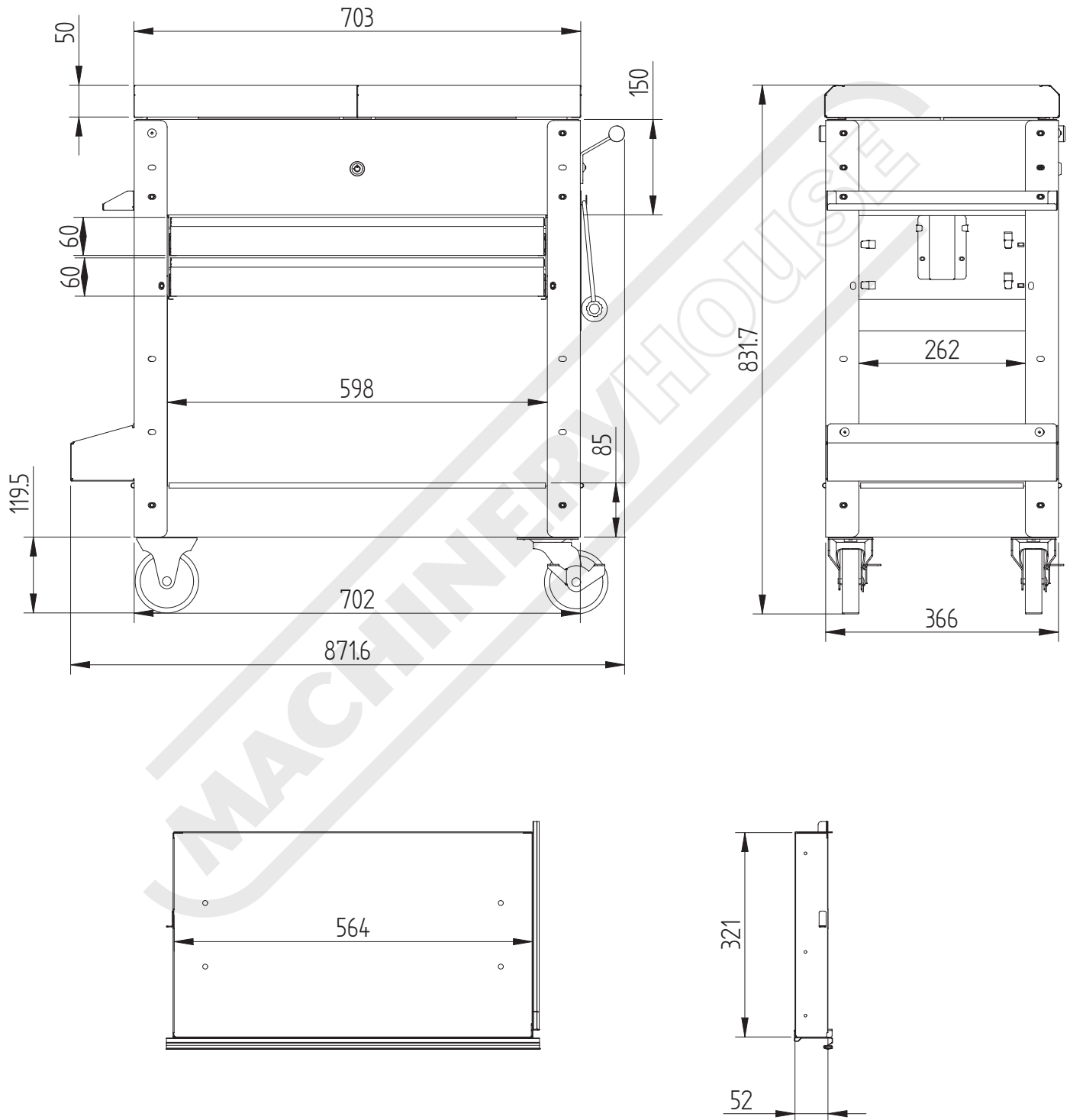



#### **ENVIRONMENT PROTECTION**

Recycle unwanted materials instead of disposing of them as waste. All tools, accessories and packaging should be sorted, taken to a recycling centre and disposed of in a manner which is compatible with the environment. When the product becomes completely unserviceable and requires disposal, drain any fluids (if applicable) into approved containers and dispose of the product and fluids according to local regulations.

Imported by

**HARE & FORBES**  
**MACHINERYHOUSE**

**Australian Distributor**

Hare & Forbes  
Machineryhouse  
Sydney - Melbourne  
Adelaide - Brisbane - Perth

Ph: 1300 202 200  
[www.machineryhouse.com.au](http://www.machineryhouse.com.au)

**MACHINERYHOUSE**

**New Zealand Distributor**

Machineryhouse  
Auckland  
Christchurch

Ph: 0800 142 326  
[www.machineryhouse.co.nz](http://www.machineryhouse.co.nz)